



**INSTALLATION INSTRUCTIONS  
EXTENDED LENGTH BRIDGEPLATE  
REPLACEMENT, MIRAGE LIFT KIT # F9-0033**

- Be certain that these supplemental instructions are read and understood completely before installation is attempted. You should also refer to the Service/Owner Manual for additional installation instructions and safety precautions.
- Check contents of this kit and notify Ricon immediately of any missing parts. Claims for damages that have occurred during shipping must be made to the shipper.

<b>TABLE OF CONTENTS</b>	<b>PAGE</b>
I. INTRODUCTION .....	1
II. TOOLS REQUIRED .....	1
III. DISASSEMBLY .....	1
IV. PLATFORM PREPARATION .....	2
V. ASSEMBLY .....	2

**I. INTRODUCTION**

The following instructions outline the step-by-step instructions on how to replace an existing 10" bridgeplate with a 15" bridgeplate.

**II. TOOLS REQUIRED**

Screwdriver	Pliers	Countersink	Drill
-------------	--------	-------------	-------

**III. DISASSEMBLY**

- A. Remove and discard stirrup assembly **Figure [1]**, (item-1) by removing the shock (item-2).
- B. Remove and discard bridgeplate (Item-3) by detaching the pivot bracket (Item-4) from the inner walls of the platform.

## IV. PLATFORM PREPARATION

- A. Countersink the two existing holes from the inner wall of the platform **Figure 2-A**.
- B. Drill 4 ea. new holes into the walls of the platform, and countersink them from the outside wall per dimensions in **Figure 2-B**.

## V. ASSEMBLY

- A. BRIDGEPLATE INSTALLATION. Refer to **Figure [3]**.
  - 1. Attach the pivot bracket **Figure [3]**, (item-1) to the supplied bridgeplate (Item-2) using enclosed hardware.
  - 2. Install the supplied spring (Item-3) between the bridgeplate (Item-2) and the pivot bracket (Item-1).
  - 3. Attach the bridgeplate (Item-2) to the platform using the enclosed hardware.
- B. STIRRUP INSTALLATION. Refer to **Figure [4]**.
  - 1. Attach supplied shock **Figure [4]**, (item-1) to the new stirrup assembly (Item-2) using supplied hardware.
  - 2. Install the stirrup assembly (Item-2) to the platform using supplied hardware.

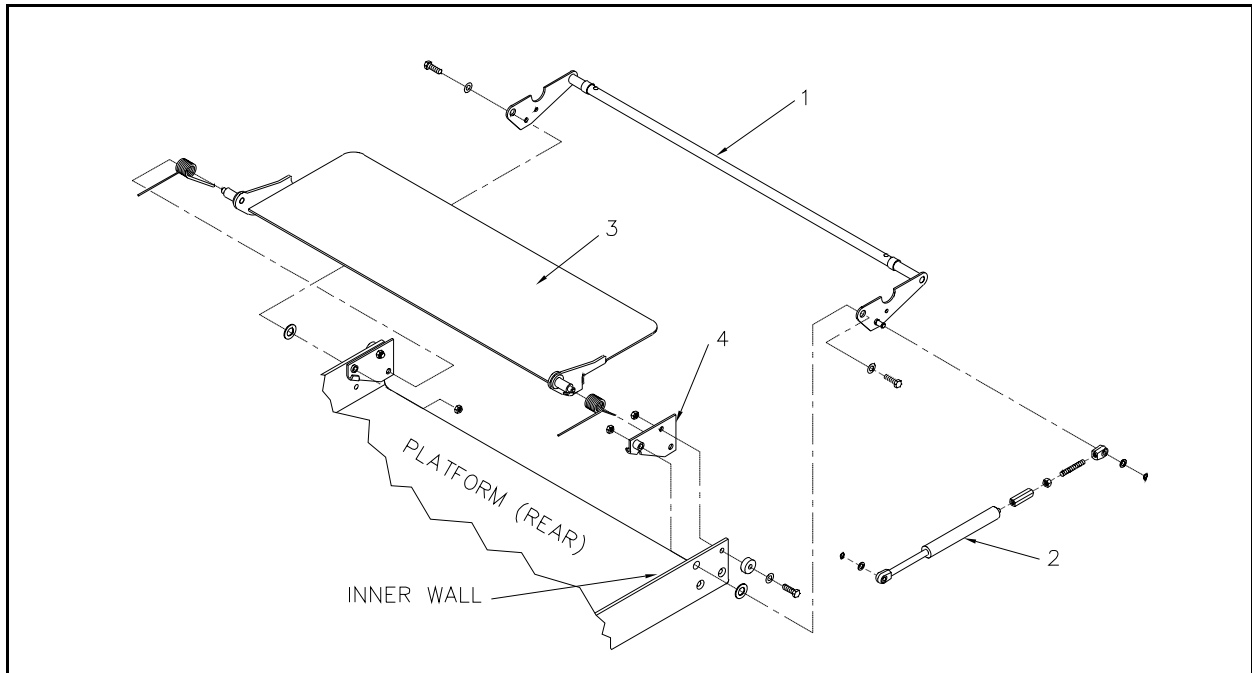

FIGURE [1]

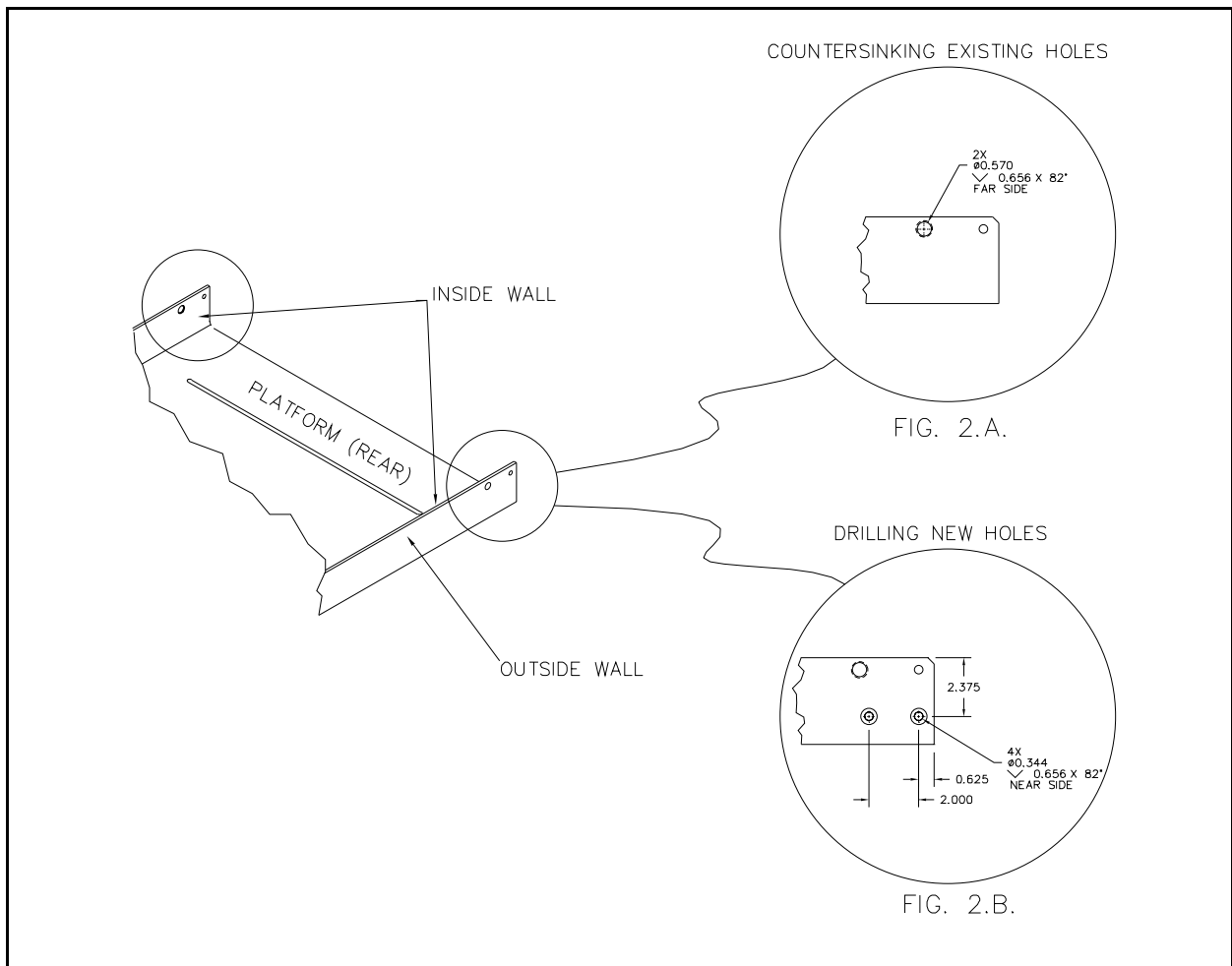

FIGURE [2]

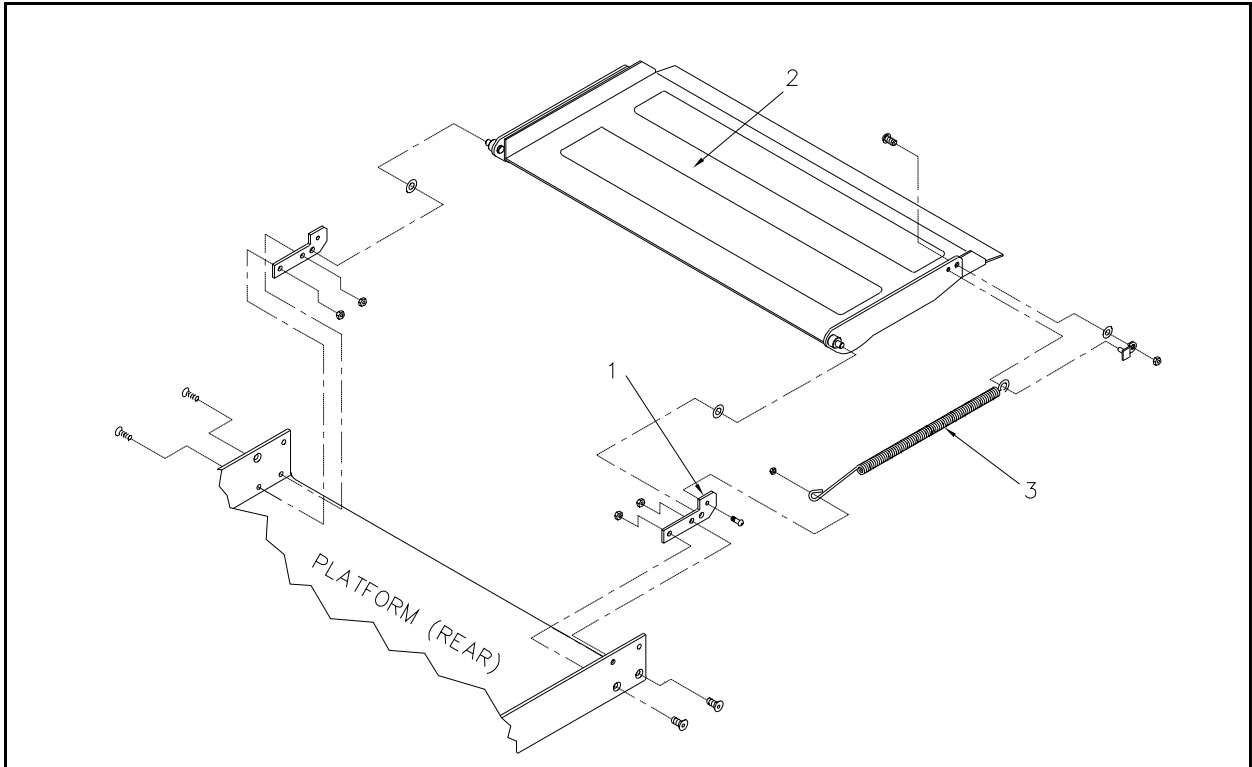

FIGURE [3]

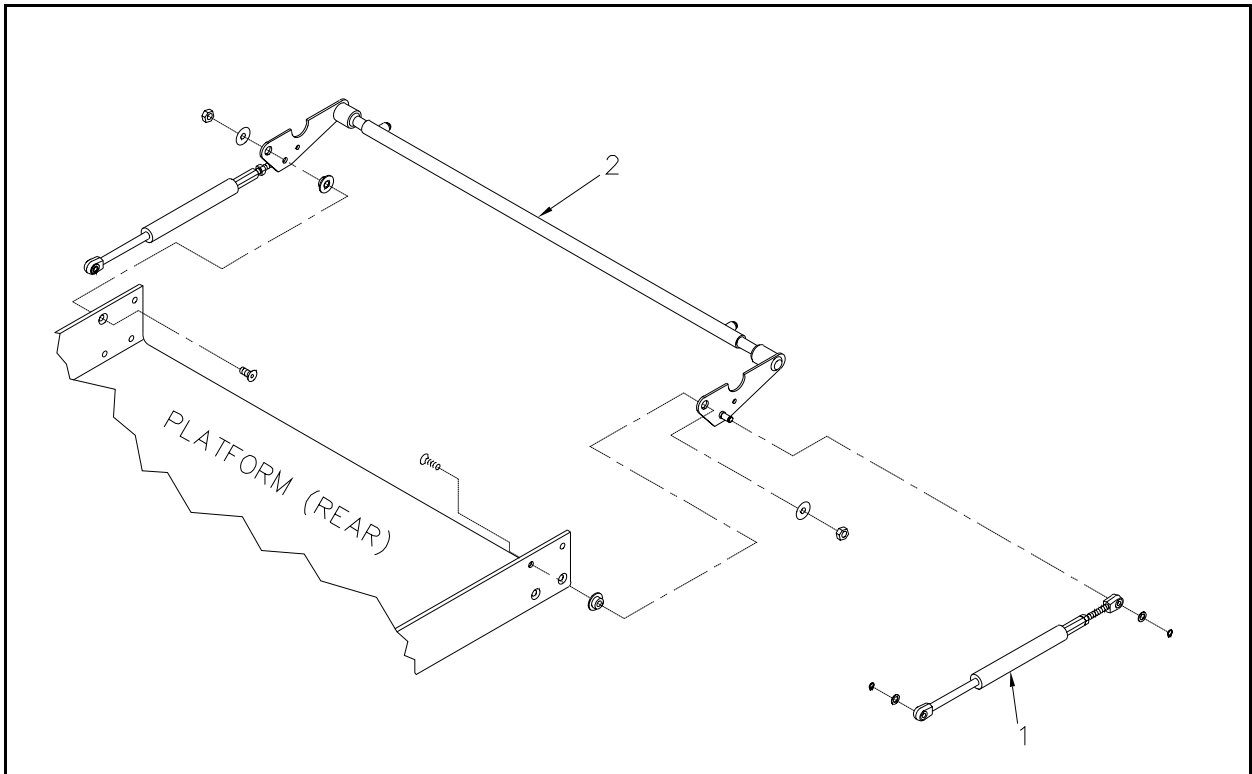

FIGURE [4]