



INSTALLATION INSTRUCTIONS
S-SERIES LIFTS LATCH MECHANISM ASSEMBLY MODIFICATION
KIT# 01099

- Read and understand supplemental instructions completely before installation is attempted. Refer to the Service/Owner Manual for additional installation instructions and safety precautions.
- Check contents of kit. Immediately notify Ricon of any missing parts. Claims for damages that have occurred during shipment must be made to the shipper.

TABLE OF CONTENTS	PAGE
I. TOOLS REQUIRED	1
II. INTRODUCTION	1
III. DISASSEMBLY PROCEDURE	1
IV. ASSEMBLY PROCEDURE	2

I. TOOLS REQUIRED

Needle Nose Pliers
Red Grease

3/16", 5/32" Hex Wrenches
loc-TITE® Blue

II. INTRODUCTION

The following instructions outline the step by step modification of the Latch Mechanism Assembly on S-Series Lifts, S/N's 32000+.

III. DISASSEMBLY PROCEDURE

A. REFER TO **FIGURE [1]** FOR ILLUSTRATION OF INBOARD ROLLSTOP.

- < Remove and discard base latch catch (item 12) from bottom of inboard rollstop.

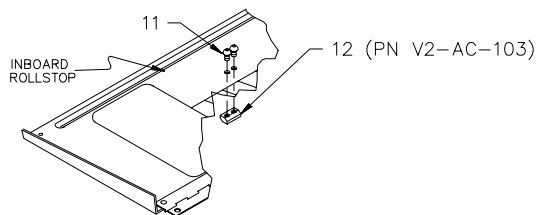

FIGURE: [1]

B. REFER TO **FIGURE [2]** FOR ILLUSTRATION OF BASE PLATE.

1. Remove base latch cover (Item 1) from the right side of the lift base plate.
2. Refer to **Figure [2]**. Remove hex bolt from base assembly.
3. Remove and discard the sto-loc release spring (item 5) mounted between the latch assembly (item 6) and the base assembly spring mounting pin (item 10) located on the right side of the lift base plate.

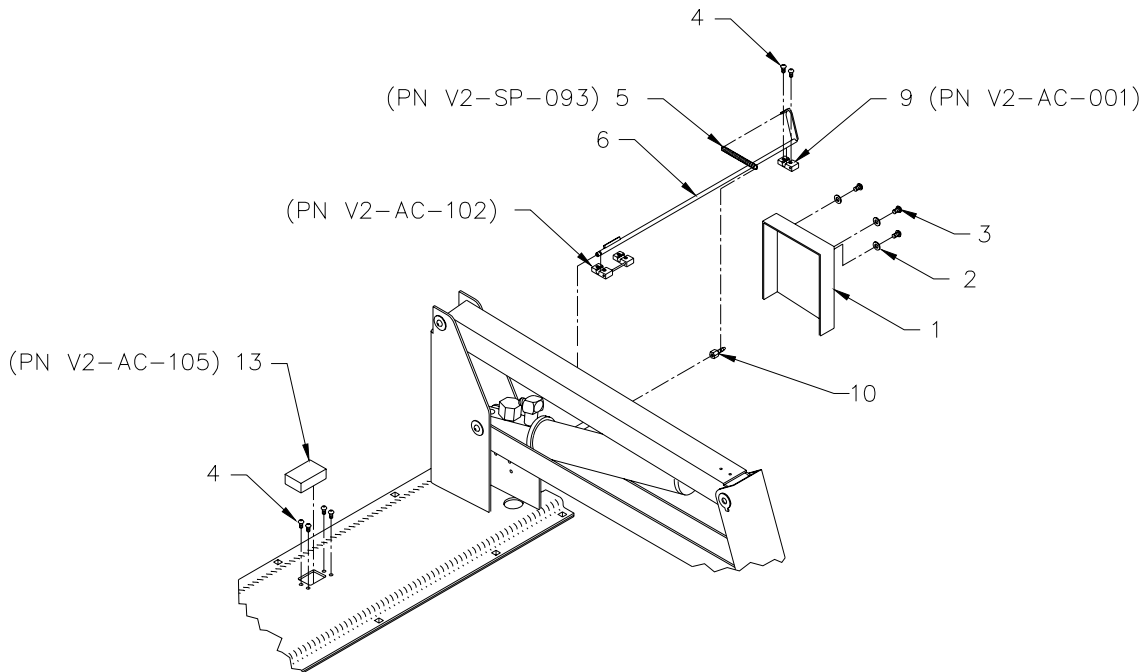

Figure [2]

4. Remove four (4) screws (item 4) located in the middle of the lift base plate.
5. Remove two screws (item 4) located on the right-side of the lift base plate.

NOTE: If the lift base plate is 32 inches wide, these two (2) screws on the right-side of the lift base plate will be found inside the base assembly tower. To remove them, the platform must be raised to approximately 10 inches below floor level.

6. Once all six (6) screws have been removed from the lift, rotate the latch assembly rod clockwise slightly to free latching catch, and slide rod far enough to the right of the lift to gain access to the mounting block (item 9) located on the spring-end of the rod.
7. Remove and discard the mounting block.

IV. ASSEMBLY PROCEDURE

A. REFER TO **FIGURE [2]** FOR ILLUSTRATION OF BLOCK REPLACEMENT

1. Attach replacement mounting block (item 9) to the spring end of the rod (item 6).
2. Apply grease to block (item 9) and rod (item 6), and re-insert rod through base plate to its original position.
3. Using loc-TITE® Blue, secure the latch mechanism assembly to the lift base plate by re-inserting and tightening all six (6) screws (item 4) removed in section III.B.4. & 5. Do not torque screws. The rod (item 6) should rotate freely in mounting blocks.
4. Apply supplied glue to the bottom of the catch control block (item 13), and insert block into center hole of base plate. The block should be located 1/8" behind the latch. Allow glue to set for at least 30 minutes before attempting to operate the lift.

B. SPRING REPLACEMENT

1. Refer to **Figures [2] and [3]**. Attach replacement sto-loc release spring (item 5) between the latch assembly (item 6) and the base assembly spring mounting pin (item 10). Actuate latch assembly several times and observe for smooth operation. If either end of spring comes off, re-install and crimp respective spring-end.
2. Re-install and tighten hex bolt removed in section III.B.2. Refer to **Figure [3]**.
3. Replace latch cover (item 1) to its original location.

C. CATCH REPLACEMENT

1. Refer to **Figure [1]**. Attach replacement base latch catch (item 12) to the bottom of inboard rollstop using hex screws (item 11). Be sure the chamfered edge of the catch is facing the inside of the vehicle.
2. The catch can be adjusted on the rollstop by either moving the catch to a different hole or flipping the catch upside down. Once again, be sure the chamfered edge of the catch is facing the inside of the vehicle.

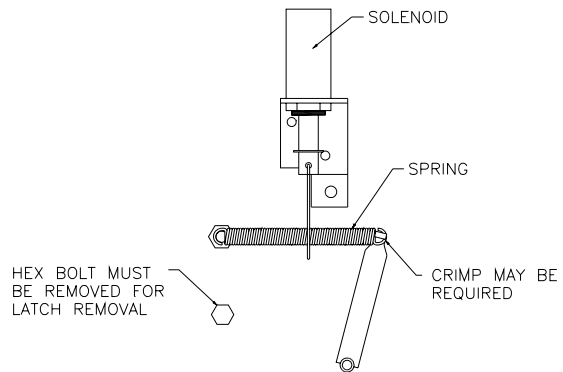

FIGURE [3]

NOTES