

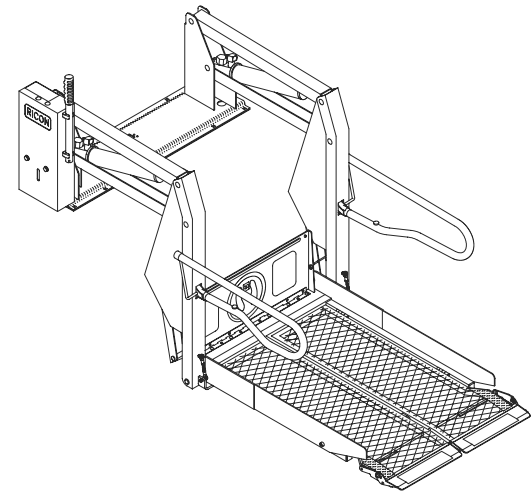

**S-Series
Export Use™
Wheelchair and Standee Lift
with Folding Platform**

-PRINT-



Operator Manual

07/07/10

32DSSE01.B

©1994-2010 RICON CORPORATION

-HOME-

All Rights Reserved



U.S. Patent Nos: 4,534,450; 5,308,215; 5,445,488; 5,605,431; 5,944,473

Australian Patent No: 687,066 Canadian Patent No: 1,245,603

Other U.S. and foreign patents pending.

Printed in the United States of America

THIS RICON PRODUCT MUST BE INSTALLED AND SERVICED BY A RICON AUTHORIZED DEALER.

PRODUCT USERS MUST REFER TO THIS MANUAL FOR OPERATING AND GENERAL MAINTENANCE INSTRUCTIONS.

RETAIN THIS MANUAL IN THE VEHICLE FOR FUTURE REFERENCE.

Customer Information	
Customer name	
Installing dealer	
Date installed	
Serial number	

REVISION RECORD

REV	PAGES	DESCRIPTION OF CHANGE	ECO
32dsse01.B		Update to cover.	6560
	1-1	Update to Contact information.	
	1-2	Update to Warranty statement.	
	2-1, 2	Update to Safety Precautions.	
	2-6	Added Pump Solenoid LED Status Indicator section.	
	2-7	Update to Lift Operation.	
	3-1	Added Additional Maintenance Information section.	
END OF LIST			

S-SERIES EXPORT USE TABLE OF CONTENTS

<i>Chapter:</i>	<i>Page</i>
I. INTRODUCTION	1-1
A. RICON LIFT WARRANTY.....	1-2
B. SHIPMENT INFORMATION.....	1-3
C. GENERAL SAFETY PRECAUTIONS	1-3
D. MAJOR LIFT COMPONENTS	1-4
II. OPERATING INSTRUCTIONS	2-1
A. SAFETY PRECAUTIONS.....	2-1
B. DAILY SAFETY CHECK	2-2
C. LIFT FUNCTIONS	2-3
D. CONTROLS AND INDICATORS.....	2-4
• CONTROL PENDANT	2-4
• INTERLOCK INDICATOR LIGHT	2-5
• OPTIONAL DOOR OPERATOR CIRCUIT BREAKER	2-5
• CONTROL SYSTEM CIRCUIT BREAKER.....	2-5
• PUMP SOLENOID LED STATUS INDICATOR	2-6
• MAIN CIRCUIT BREAKER.....	2-6
• MANUAL BACK-UP PUMP	2-6
E. LIFT OPERATION.....	2-7
1. ENTERING VEHICLE	2-8
2. EXITING VEHICLE	2-8
3. STOWING PLATFORM	2-9
4. MANUAL OPERATION.....	2-9
F. MAINTENANCE AND REPAIR NOTE	2-11
III. MAINTENANCE	3-1
A. MAINTENANCE INFORMATION	3-1
B. CLEANING	3-1
C. MAINTENANCE SCHEDULE	3-1
D. LIFT DECALS	3-3

LIST OF FIGURES

<i>Figure</i>	<i>Page</i>
1-1 EXPORT USE WHEELCHAIR AND STANDEE LIFT	1-4
2-1 SLOPED PARKING HAZARD	2-1
2-2 FACING OUTWARD IS SAFEST	2-1
2-3 STAND CLEAR OF LIFT	2-2
2-4 PLATFORM POSITIONS	2-3
2-5 CONTROL PENDANT	2-4
2-6 INDICATOR LIGHT/CIRCUIT BREAKERS	2-5
2-7 MAIN CIRCUIT BREAKER	2-6
2-8 MANUAL BACKUP PUMP & HANDLE	2-6
2-9 MANUAL OPERATION	2-9
2-10 MANUAL BACK-UP PUMP – DEPLOY OR LOWER PLATFORM	2-10
2-11 MANUAL BACK-UP PUMP – RAISE PLATFORM	2-10
3-1 DECAL LOCATIONS AND PART NUMBERS	3-3

LIST OF TABLES

<i>Table</i>	<i>Page</i>
1-1 S-SERIES LIFT TERMINOLOGY	1-5
2-1 LIFT FUNCTIONS	2-3
3-1 MAINTENANCE SCHEDULE	3-1

I. S-SERIES EXPORT USE INTRODUCTION

The RICON S-Series™ Export Use Wheelchair and Standee Lift with Folding Platform provides wheelchair access to personal vans. The patented movement provides smooth, safe entry and exit and easily lifts up to 364 kilograms (800 pounds). It is operated by the wheelchair occupant or a trained attendant. The lift contains a powerful electro-hydraulic pump that includes a built-in manual backup pump. If lift loses electrical power, it can be raised or lowered manually.

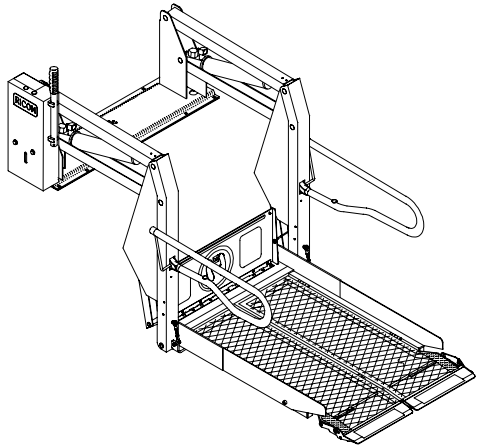

By using lift control switches, the lift is unfolded out from vehicle (deployed). The user boards the large, non-skid platform and then uses the control switches to gently lower the platform to the ground. After the user departs, the platform is raised and folded into vehicle (stowed). The platform splits and folds when stowed, providing easy vehicle access through the lift.

This manual contains warranty information, safety precautions, and operating instructions. It is important to user safety that lift operator be completely familiar with the operating instructions. Once the lift is installed, it is very important that the lift be properly maintained by following the Ricon recommended cleaning, maintenance, and inspection instructions given in Chapter III.

If there are questions about this manual, or additional copies are needed, please contact Ricon Product Support at one of the following locations:

Ricon Corporation
7900 Nelson Road
Panorama City, CA 91402
Telephone:(818) 267-3000
.....(800) 322-2884

Vapor Ricon Europe Ltd
Littlemoss Business Park
Littlemoss Road
Droylsden
Manchester, M43 7EF: +44 (0)161 3016000
World Wide Website:www.RiconCorp.com

A. RICON FIVE-YEAR LIMITED WARRANTY

RICON CORPORATION FIVE-YEAR LIMITED WARRANTY

Ricon Corporation (Ricon) warrants to original purchaser of this product that Ricon will repair or replace, at its option, any part that fails due to defective material or workmanship as follows:

- Repair or replace parts for a period of one year from date of purchase.
- Labor costs for specified parts replace under this warranty for a period of one year from date of purchase. A Ricon rate schedule determines the parts covered and labor allowed.
- Repair or replace lift power train parts for a period of five years from date of purchase. A list of parts covered can be obtained from your Ricon dealer or Ricon Product Support.

If You Need to Return a Product: Return this Ricon product to your installing dealer. Please give advance notice, and allow a reasonable amount of time for repairs.

If You are Traveling: All Ricon authorized dealers honor this warranty. Consult telephone directory or call Ricon Product Support for the name of the nearest Ricon authorized dealer.

This Warranty does not Cover:

- Malfunction or damage to product parts caused by accident, misuse, lack of proper maintenance, neglect, improper adjustment, modification, alteration, the mechanical condition of vehicle, road hazards, overloading, failure to follow operating instructions, or acts of Nature (i.e., weather, lightning, flood).

Note: Ricon recommends that this product be inspected by a Ricon authorized dealer at least once every six months, or sooner if necessary. Any required maintenance should be performed at that time.



WARNING

THIS PRODUCT HAS BEEN DESIGNED AND MANUFACTURED TO EXACT SPECIFICATIONS. MODIFICATION OF THIS PRODUCT IN ANY RESPECT CAN BE DANGEROUS.

This Warranty is Void if:

- The product has been installed or maintained by someone other than a Ricon dealer or qualified service technician.
- The product has been modified or altered in any respect from its original design without written authorization by Ricon.

Ricon disclaims liability for any personal injury or property damage that results from operation of a Ricon product that has been modified from the original Ricon design. No person or company is authorized to change the design of this Ricon product without written authorization by Ricon.

Ricon's obligation under this warranty is exclusively limited to the repair or exchange of parts that fail within the applicable warranty period.

Ricon assumes no responsibility for expenses or damages, including incidental or consequential damages. Some states do not allow the exclusion or limitation of incidental or consequential damages, so the above limitation or exclusion may not apply.

Important: The warranty registration card must be completed and returned to Ricon within 20 days after installation of this Ricon product for the warranty to be valid. The warranty is not transferable.

The warranty gives specific legal rights, and there may be other rights that vary from state to state.

B. SHIPMENT INFORMATION

Ricon does not sell directly to the user because of the specialized nature of this product. The product is distributed through a worldwide network of Ricon authorized dealers who perform actual installation.

- When the product is received, unpack it and check for freight damage. Claims for any damage should be made to freight carrier immediately.
- Be sure installation kit contains all items listed on kit packing list. **Please report any missing items immediately to Ricon Product Support.** The warranty and owner's registration cards must be completed and returned to Ricon within 20 days for the warranty to be valid.

NOTE

The Sales/Service Personnel must review Warranty and Owner Manual with user to be certain that they understand safe operation of product. Instruct user to follow operating instructions without exception.

C. GENERAL SAFETY PRECAUTIONS

The following general safety precautions must be followed during operation:

- To avoid injury, always exercise caution when operating and be certain that hands, feet, legs, and clothing are not in the path of product movement.
- Read and thoroughly understand operating instructions before attempting to operate the lift.
- Inspect product before each use. Do not operate lift if an unsafe condition is present, or there is unusual noise or movement.
- Keep others clear during lift operation.
- The lift requires regular maintenance. Ricon recommends a thorough inspection every six months. Maintain the product at its highest level of performance.

D. MAJOR LIFT COMPONENTS

The references used throughout this manual are illustrated in **Figure 1-1** and defined in **Table 1-1**. Refer to the **Service Manual, Chapter IV, "Parts and Diagram Lists"** for more details.

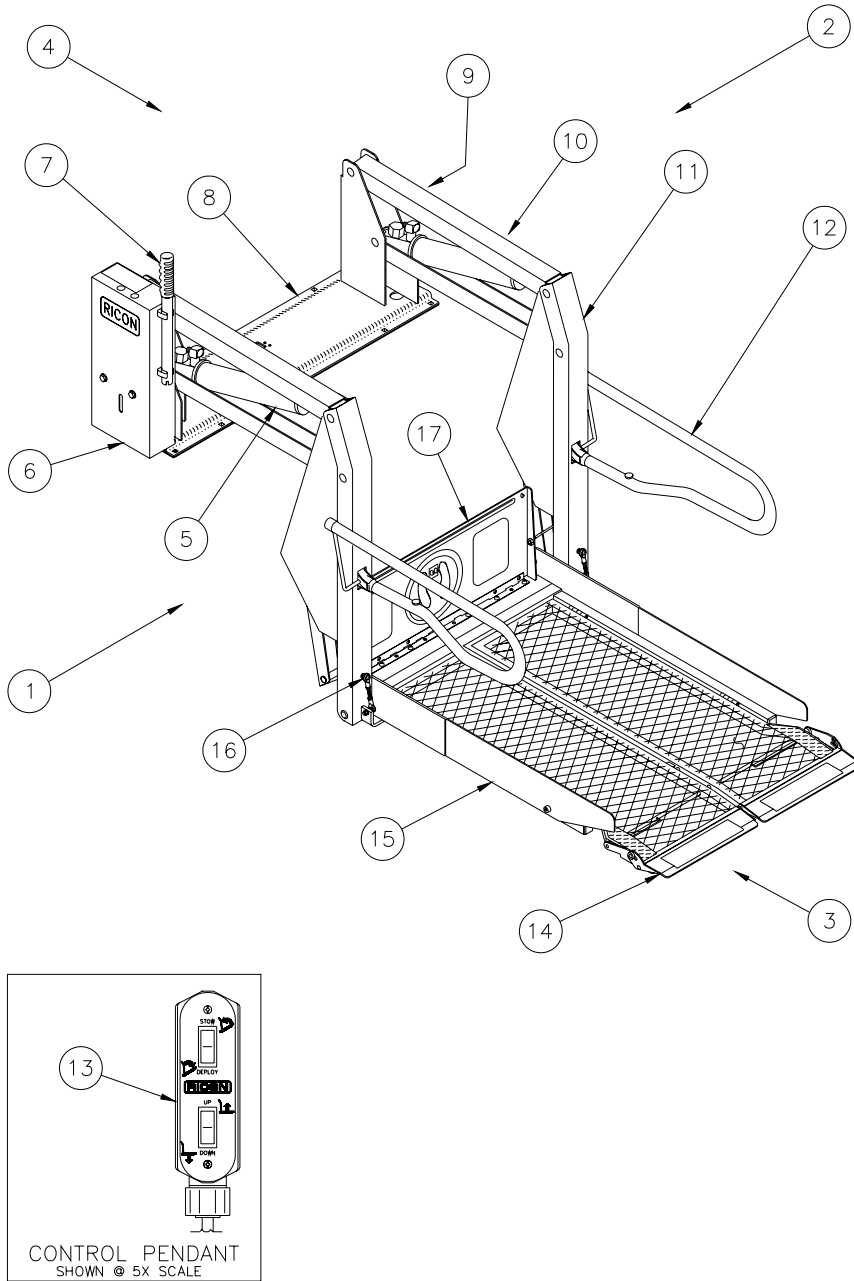

FIGURE 1-1: EXPORT USE WHEELCHAIR AND STANDEE LIFT

TABLE 1-1: S-SERIES LIFT TERMINOLOGY		
REF	NAME	DESCRIPTION
1	Left	Position references when lift is viewed from outside of vehicle.
2	Right	
3	Front	
4	Rear	
5	Hydraulic Cylinder	(Left and Right) Telescoping steel tube converts hydraulic pressure into lifting force.
6	Hydraulic Power Unit	Contains pump used to create hydraulic pressure to raise and fold lift, as well as a valve to unfold and lower lift.
7	Manual Backup Pump Handle	Used to operate manual back up-pump when electrical power is not functional.
8	Baseplate Assembly	Assembly that bolts securely to vehicle floor.
9	Serial Number location	Location of serial number decal.
10	Top/Bottom Arms	(Left/Right) Upper and lower links connecting vertical arm to base assembly.
11	Vertical Arm	(Left/Right) Connects platform and top/bottom arms.
12	Handrail	(Left/Right) Provide stable handhold for occupant.
13	Control Pendant	Hand-held device used to control operating functions.
14	Front Rollstop	Front barrier prevents wheelchair from slow, inadvertent rolling off of platform during lift operation.
15	Platform	Component of lift where wheelchair and occupant sit during "Up" and "Down" operations.
16	Tie-Rod	(Left/Right) Mechanical links that cause platform to fold as it is stowed.
17	Bridgeplate (Inboard Rollstop)	Barrier to prevent wheelchair from rolling off of platform during lift operation.
END OF TABLE		

This page intentionally left blank.

II. S-SERIES EXPORT USE OPERATING INSTRUCTIONS

This chapter contains safety precautions, daily safety check instructions, control and indicator descriptions, and operating instructions for the RICON S-Series Export Use Wheelchair and Standee Lift with Folding Platform. This chapter must be thoroughly understood by operator before attempting to use lift.

A. SAFETY PRECAUTIONS

The following safety precautions must be complied with at all times when operating lift:

- Refer to **Figure 2-1**. Deploying lift when vehicle is on sloped ground is hazardous. Operate lift with vehicle parked on level ground.
- Vehicle must be safely parked with parking brake ON before using lift.

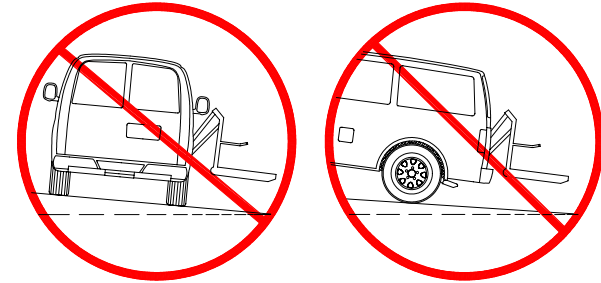

FIGURE 2-1: SLOPED PARKING HAZARD

- Inspect lift before use. **DO NOT** use lift if any unsafe condition exists, or unusual noises or movements are noticed, and contact an authorized Ricon service technician for repair.
- Read and comply with all warning labels and symbols affixed to wheelchair lift.
- Refer to **Figure 2-2**. Wheelchair occupant must face outward on platform when entering or exiting vehicle to minimize the possibility of the large rear wheels rolling up and over the front rollstop.



FIGURE 2-2: NEVER ENTER OR EXIT VEHICLE WHILE FACING BACKWARDS ON THE LIFT

- **DO NOT** back onto platform when exiting vehicle. **FACE OUTWARD**, if possible, and make sure that platform is at the same level as floor. Check that outer rollstop is up and locked.
- The outer rollstop is intended to prevent slow, or unintentional, rolling off the platform. The outer rollstop is not designed to stop a quick moving wheelchair. The wheelchair might tip and possibly injure its occupant if the small front wheels collide hard with the rollstop. The large rear wheels of a quick moving wheelchair can roll over the rollstop. Use great care,

board platform slowly, and lock wheelchair brakes.

- Do not place equipment or furniture inside vehicle that may prevent pivoting of your wheelchair. Being able to pivot assures that you can safely exit facing outward.
- Be certain wheelchair fits safely on platform; it must not extend beyond edges or interfere with operation of rollstop.
- Do not operate with a load in excess of 364kg (800 lbs).
- Keep arms, legs, and clothing away from moving lift parts.
- The lift is intended for ONE wheelchair and its occupant. Do not overload lift.
- Refer to **Figure 2-3**. Do not stand in front of lift while deploying platform.



FIGURE 2-3: STAND CLEAR OF PLATFORM

- Keep other clear while operating lift.
- Do not allow an untrained person to operate lift.
- Careful supervision is necessary if used by or near children.
- Do not allow anyone to stand on bridgeplate. A bent bridgeplate can interfere with the platform as it raises and lowers.
- LOCK WHEELCHAIR BRAKES before moving platform (power chair users should turn off power and set brake).
- Use great care in wet conditions, because the wheelchair brakes are less effective if wheels or platform are wet.
- Never leave platform outside of vehicle. Return lift to stowed position after use.
- Do not place a wheelchair on lift if it is too large for the vehicle. The wheelchair must be able to pivot freely inside vehicle to comply with lift instructions for entering and exiting vehicle.



Read and understand these safety precautions. Review them periodically and ask any attendants or other operators to read them as well. Contact a Ricon authorized or call Ricon Product Support if there are questions.

B. DAILY SAFETY CHECK

Inspect lift before each use and check that following conditions are met before operating:

- All functions operate properly. DO NOT use if unusual noises or movements exist, and contact a Ricon authorized dealer or qualified service technician for repair.
- Vehicle interlock is operating properly.
- Objects that may interfere with operation are not present.
- General appearance and lubrication are satisfactory and all fasteners are tight.

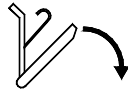
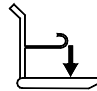
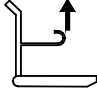
C. LIFT FUNCTIONS

TABLE 2-1: LIFT FUNCTIONS	
FUNCTION	DESCRIPTION
	DEPLOY Platform unfolds/deploys out of vehicle from stowed position. (If equipped with a power door operator, the doors automatically open before lift deploys.)
	DOWN Platform is lowered from vehicle floor level position to ground level. (The front rollstop automatically lowers when platform reaches ground level.)
	UP Platform is raised from ground level to vehicle floor level. (The front rollstop automatically rises when platform leaves ground level.)
	STOW Platform folds/stows from vehicle floor level to stowed position. (If equipped with a power door operator, the door) automatically close after lift stows.)
END OF TABLE	

NOTE: The up and down functions do not operate if platform is stowed.

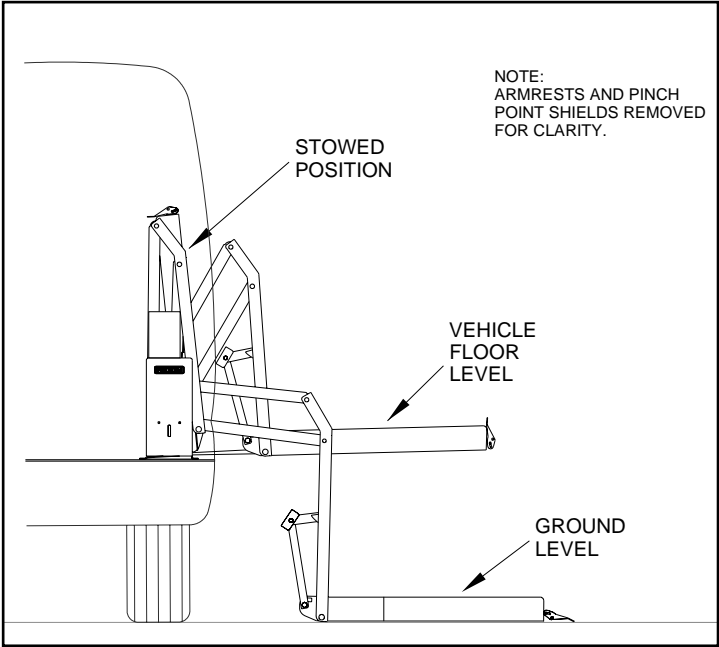

FIGURE 2-4: PLATFORM POSITIONS

D. CONTROLS AND INDICATORS

WARNING

THE LIFT CAN OPERATE ONLY WHEN VEHICLE MANUFACTURER INTERLOCK CIRCUITRY IS ACTIVATED. NEVER ATTEMPT TO OPERATE LIFT WITH INTERLOCK BYPASSED. REFER TO VEHICLE OWNER/OPERATOR MANUAL FOR INTERLOCK INSTRUCTIONS BEFORE OPERATING LIFT.

■ Control Pendant

Refer to **Figure 2-5**. The lift is operated with two rocker buttons located on a hand-held, hard-wired remote-control pendant. Each lift function is controlled by pushing one end of the appropriate button. Pushing the DEPLOY button unfolds platform from vehicle, and pushing the STOW button folds platform into vehicle. Pushing the DOWN button lowers platform towards ground, and pushing the UP button raises platform towards floor. Buttons must be held depressed until function completes. The pendant is stowed on a wall-mounted clip inside vehicle.

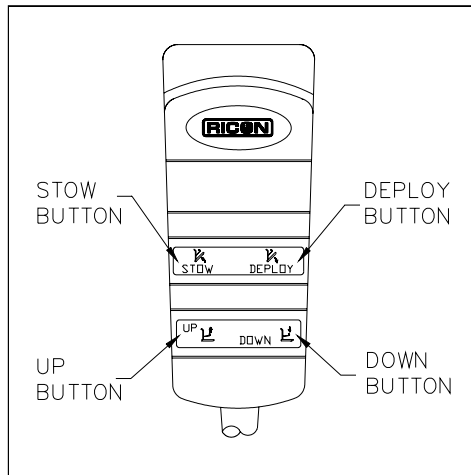

FIGURE 2-5: LIFT CONTROL PENDANT

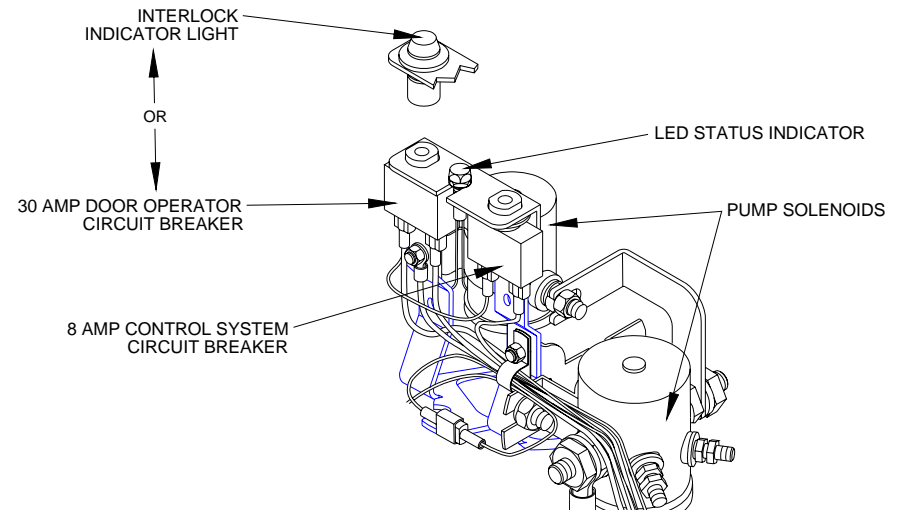

FIGURE 2-6: INDICATOR LIGHT, CIRCUIT BREAKERS, AND LED INDICATOR

- Interlock Indicator Light

Refer to **Figure 2-6**. The purpose of a vehicle interlock system is to prevent operation of lift if an unsafe condition is present. When vehicle interlock systems are interfaced with lift circuitry, the interlock indicator shows whether or not interlock is operating properly. The light is interfaced with electrical system so that no matter which interlock system/method is used, the light will be ON when interlock allows electrical power to lift and OFF when interlock has disabled power to lift. When there is no interlock system installed, the light stays illuminated at all times.

- Circuit Breaker for Optional Door Operator

Refer to **Figure 2-6**. The circuit breaker for optional door operator is found on hydraulic pump assembly. In case of a door operator short circuit, the circuit breaker button will “pop-out”. If pressing and releasing button does not reset power, **DO NOT** press and hold. Contact an authorized Ricon service technician for repair. Refer to appropriate Ricon Remote Power Door Operator Service/Owner Manual for a detailed description.

- Control System Circuit Breaker

Refer to **Figure 2-6**. The Control System Circuit Breaker is on hydraulic pump assembly. In case of a control system short circuit, circuit breaker button will “pop-out”. If pressing and releasing button does not reset power, **DO NOT** press and hold. Contact an authorized Ricon service technician for repair.

- Pump Solenoid LED Status Indicator

Refer to **Figure 2-6**. A second pump solenoid is installed next to the original pump solenoid and a LED is located between the 8A and 30A circuit breakers. The LED monitors the condition of the two solenoids. The LED is normally green when the pump is operating and off when the pump is off. For more information on this LED refer to the service manual 32DSSE02.

- Main Circuit Breaker

Refer to **Figure 2-7**. The main circuit breaker is located in vehicle engine compartment and is designed to interrupt electrical power to lift electrical system when a short circuit occurs. In the event of a short circuit, the circuit breaker reset tab will “flip-down”. If pressing reset tab UP and releasing does not reset power, **DO NOT** press and hold tab. Contact an authorized Ricon service technician for repair.

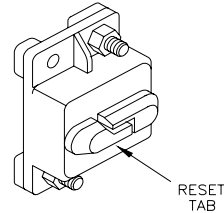

FIGURE 2-7: MAIN CIRCUIT BREAKER

- Manual Backup Pump

Refer to **Figure 2-8**. The manual backup pump is used to operate lift if electrical power is not functional. The controls for pump consist of a pump handle for raising lift platform and a pump release valve for lowering it. Instructions for operating manual pump are provided in the MANUAL OPERATION paragraph, which is part of the LIFT OPERATION section in this chapter.

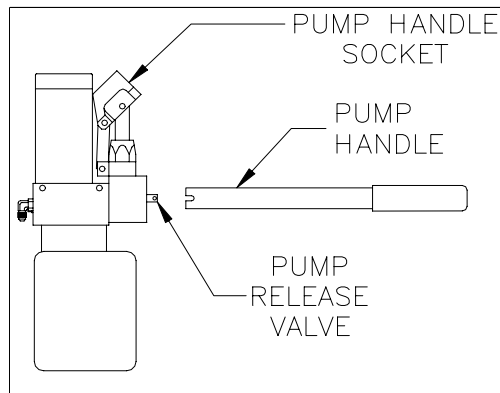

FIGURE 2-8: MANUAL BACKUP PUMP & HANDLE

E. LIFT OPERATION



WARNING

IMPROPER USE OF LIFT CAN RESULT IN PERSONAL INJURY. USERS MUST READ AND FOLLOW OPERATING INSTRUCTIONS IN OPERATOR MANUAL. ADDITIONAL COPIES OF OPERATOR MANUAL ARE AVAILABLE FROM:

RICON CORPORATION
7900 NELSON ROAD
PANORAMA CITY, CA 91402
(800) 322-2884 OR (818) 267-3000

- DO NOT EXCEED RATED LOAD CAPACITY OF 800 POUNDS (364 KG).
- PRIOR TO USE, INSPECT WHEELCHAIR LIFT FOR PROPER FUNCTION, REQUIRED MAINTENANCE, OR DAMAGE. IF A PROBLEM EXISTS, DO NOT USE LIFT AND CONTACT A RICON AUTHORIZED DEALER OR QUALIFIED SERVICE TECHNICIA FOR REPAIR.
- THIS LIFT IS DESIGNED FOR USE BY WHEELCHAIR OCCUPANTS ONLY.

RICON CORPORATION DISCLAIMS LIABILITY FOR DAMAGE OR PERSONAL INJURY RESULTING FROM MODIFICATION TO LIFT, LACK OF MAINTENANCE OR REPAIR, NEGLIGENCE, ABUSE, OR FAILURE TO FOLLOW LIFT OPERATING INSTRUCTIONS.

- Be certain vehicle is safely parked on a level area away from traffic before operating lift. Allow space for lift operation and passenger boarding.
- The lift operator must take special care to be certain that area is clear before deploying lift. Be certain there are no obstacles beneath platform.
- Open doors manually if vehicle is not equipped with a Power Door Operator. The vehicle door(s) will open automatically before platform deploys and close after platform is stowed, if vehicle is equipped with a Power Door Operator.
- Engage the vehicle safety interlock system (e.g. transmission, parking brake, etc), if so equipped, before operating lift. The lift **will not** operate until this is accomplished.



WARNING

ATTENDANT SHOULD ALWAYS REMAIN NEAR PASSENGER TO RENDER IMMEDIATE ASSISTANCE IF NECESSARY. KEEP OTHERS CLEAR WHEN OPERATING LIFT. MAINTAIN PRESSURE ON SWITCH UNTIL FUNCTION IS COMPLETE. BE CERTAIN WHEELCHAIR FITS PROPERLY ON PLATFORM AND DOES NOT CONTACT ROLLSTOP, WHICH WOULD PREVENT IT FROM LOCKING WHEN PLATFORM RISES.

1. ENTERING VEHICLE

- a. **DEPLOY PLATFORM** – Push and hold DEPLOY button until platform unfolds completely from vehicle and stops at floor level.

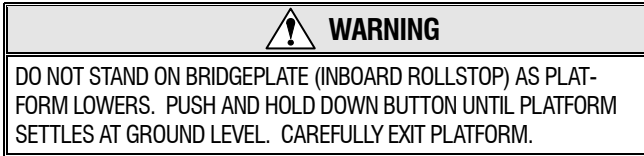

- b. **LOWER PLATFORM** - DO NOT STAND on inboard rollstop as platform lowers. Push and hold DOWN switch until lift contacts ground and front rollstop opens completely.
- c. Carefully place wheelchair centrally on platform, facing outward (away from vehicle), and LOCK WHEELCHAIR BRAKES.
- d. Be certain wheelchair is safely within platform perimeter and does not interfere with operation of front rollstop.



NOTE: STANDEES must stand in center of platform facing direction of travel (toward vehicle).

- e. **RAISE PLATFORM** - Push and hold UP switch until platform rises and stops automatically at vehicle floor level.
- f. Release wheelchair brakes, carefully board passenger into vehicle, and secure wheelchair.

NOTE: Refer to “stowing platform” section below to stow platform.

2. EXITING VEHICLE:

- a. **DEPLOY PLATFORM** - Push and hold DEPLOY switch until platform completely unfolds from vehicle and stops at floor level.
- b. Be certain platform is safely at vehicle floor level and front rollstop is in an up and locked position.
- c. Carefully place wheelchair centrally on platform, facing outward (away from vehicle), and LOCK WHEELCHAIR BRAKES.

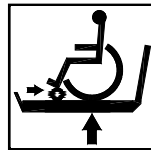

NOTE: STANDEES must stand in center of platform facing direction of travel (toward vehicle).

- d. **LOWER PLATFORM** - DO NOT STAND on bridgeplate as platform lowers. Push and hold DOWN switch until platform settles at ground level. Carefully exit platform.
- e. **RAISE PLATFORM** - Push and hold UP switch until platform rises to vehicle floor level.

NOTE: Refer to “stowing platform” section below to stow platform.

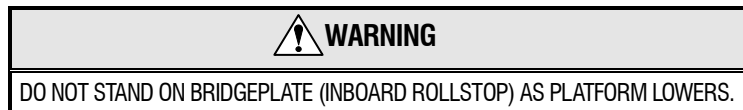

3. STOWING PLATFORM

- a. Push and hold STOW switch until platform folds completely into vehicle.

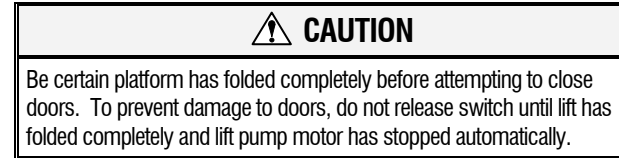

- b. Close vehicle doors if lift is not equipped with a power door operator. (If equipped with a power door operator, the vehicle door will automatically close after platform is folded and stowed.)

4. MANUAL OPERATION

Refer to **Figure 2-9**. The lift can be operated manually if electrical power is not functional.

Preparation:

- Be certain vehicle is on a level area and away from traffic. Allow enough space for lift operation and passenger boarding.
- The operator must summon emergency assistance to move vehicle to a safe operating area if a break down situation exists and vehicle cannot be moved under its own power.
- Check to be certain obstacles are not in path of lift.
- Open doors manually if vehicle is not equipped with a power door operator. If equipped with a power door operator, refer to its Operator Manual for manual operation instructions. Deploy platform.

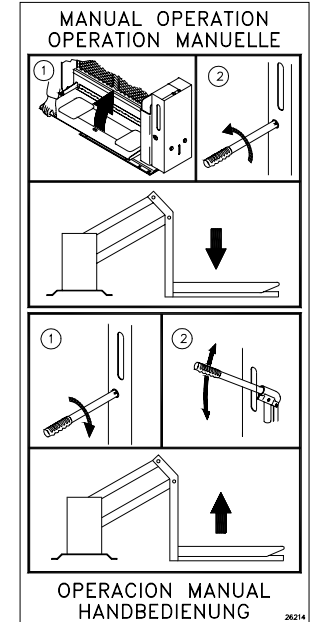
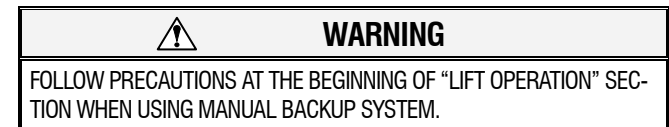

FIGURE 2-9: MANUAL OPERATION



a. Deploy Platform

- 1) Override "Sto-Loc" feature by lifting inboard rollstop. This will separate "Sto-Loc" catch (attached to underside of inboard rollstop) from "Sto-Loc" latch (affixed to lift base assembly). If "Sto-Loc" is difficult to separate, use manual pump to raise lift slightly and thereby remove tension from catch; refer to "Stow Platform" paragraph in this section.
- 2) Insert notched end of pump handle into circular hole in hydraulic pump cover (marked "RELEASE VALVE") and engage pump release valve.

CAUTION

Do not open pump pressure release valve more than **1/4-turn**. Opening valve further may cause it to disengage from pump body, which will disable pump.

- 3) Refer to **Figure 2-10**. Turn valve 1/4 turn COUNTER-CLOCKWISE to begin lowering platform. When platform reaches vehicle interior floor level turn valve CLOCKWISE to close. **DO NOT OVER-TIGHTEN VALVE**. Do not lower platform below vehicle floor level. The rear edge of bridgeplate must rest flat against vehicle floor.

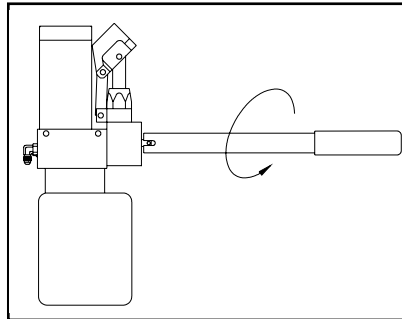

FIGURE 2-10: DEPLOY OR LOWER PLATFORM

b. Lower Platform

- 1) Turn valve 1/4 turn COUNTER-CLOCKWISE to begin lowering platform.
- 2) Hold valve OPEN until platform settles at ground level. Turn handle clockwise to close valve; **DO NOT OVER-TIGHTEN VALVE**.

c. Raise Platform

- 1) Refer to **Figure 2-11**. Check pump release valve to verify it is closed.

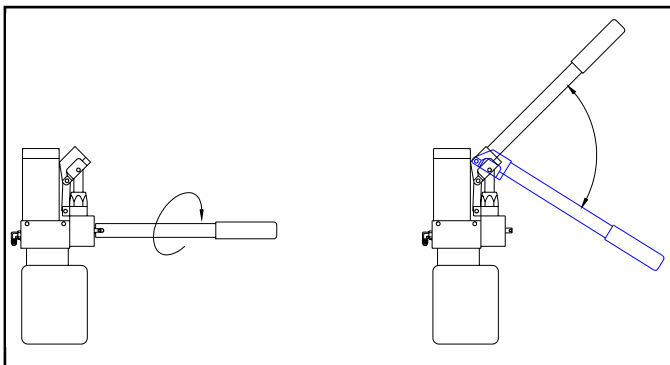

FIGURE 2-11: MANUAL BACK-UP PUMP – RAISE PLATFORM

- 2) Insert pump handle into pump handle socket. Operate pump to begin raising platform.
- 3) When platform reaches vehicle interior floor level turn valve CLOCKWISE to close. **DO NOT OVER-TIGHTEN VALVE**. Do not raise platform past vehicle floor level. The rear edge of bridgeplate must rest flat against vehicle floor.

d. Stow Platform

- 1) Refer to **Figure 2-11**. Check pump release valve to be certain it is closed; DO NOT OVER-TIGHTEN VALVE.
- 2) Insert pump handle into pump handle socket. Operate pump to begin raising platform.
- 3) Operate pump until platform is COMPLETELY folded inside vehicle.
- 4) Stow pump handle. Close vehicle doors.

F. MAINTENANCE AND REPAIR NOTE

Follow the lubrication, cleaning, and maintenance instructions in the following chapter, MAINTENANCE. These instructions will optimize the operating condition of wheelchair lift.

This page intentionally left blank.

III. S-SERIES EXPORT USE MAINTENANCE

Regular maintenance of the RICON S-Series Export Use Wheelchair and Standee Lift with Folding Platform will help optimize its performance and reduce the need for repairs. This chapter contains cleaning instructions, a maintenance schedule, and decal information.

A. ADDITIONAL MAINTENANCE INFORMATION

Additional maintenance information is available in the S-Series Export Use Service manual, part number 32DSSE02. This manual is available from Ricon in printed hard copy, or at the Ricon website in PDF format. The website is located at www.riconcorp.com. Click on RICON CORPORATION and then DEALER'S ROOM at the website. Entry to the dealer's room will require a Dealer Number and a Password.



WARNING!

THIS RICON PRODUCT IS HIGHLY SPECIALIZED. MAINTENANCE AND REPAIRS MUST BE PERFORMED BY A RICON AUTHORIZED DEALER USING RICON REPLACEMENT PARTS. MODIFYING OR FAILING TO PROPERLY MAINTAIN THIS PRODUCT WILL VOID WARRANTY AND MAY RESULT IN UNSAFE OPERATING CONDITIONS.



B. CLEANING

Regular cleaning with mild soap (i.e. dish soap, car wash liquid) and drying thoroughly will protect lift painted surfaces. Cleaning is especially important in areas where roads are salted in winter. Make sure that lift pivot points are clean and dry prior to lubrication.

C. MAINTENANCE SCHEDULE

Under normal operating conditions, maintenance inspections are required at least every six months (1750 cycles) and a thorough inspection should be performed at service intervals in **Table 3-1**. Service should be increased under conditions of heavier use (more than 10 cycles per day).

TABLE 3-1: MAINTENANCE SCHEDULE	
SERVICE POINT	ACTION TO PERFORM
DAILY SAFETY CHECK	
Overall Condition	Listen for abnormal noises as lift operates (i.e. grinding or binding noises.)
Control Pendant	Verify that control pendant is undamaged and cable connectors are tight.
TWO WEEK SAFETY CHECK	
Overall Condition	<ul style="list-style-type: none">▪ Listen for abnormal noises as lift operates (i.e. grinding or binding noises.)▪ Inspect underside of vehicle for anything that is out of place.
Control Pendant	Verify that control pendant is undamaged and cable connectors are tight.
Electrical Wiring	Inspect electrical wiring for frayed wires, loose connectors, etc.
Vehicle Interlock	Place vehicle in NON-INTERLOCK mode and attempt to operate lift.
Decals	Verify that lift decals are properly affixed, clearly visible, and legible. Replace, if necessary.

TABLE 3-1: MAINTENANCE SCHEDULE	
SERVICE POINT	ACTION TO PERFORM
Handrails	Verify that handrail fasteners are properly tightened.
Lift Mounting Points	<ul style="list-style-type: none"> ▪ Verify that vehicle mounting and support points are undamaged. ▪ Verify that mounting bolts are sufficiently tight.
Main Lifting Pivots	Verify that arm pins are properly installed, free from damage, and locked in position.
Platform Pivot Points	Verify that platform moves freely, without binding, and does not wobble.
Bridgeplate (Inner rollstop)	<ul style="list-style-type: none"> ▪ Verify that bridgeplate operates without binding during lift functions. ▪ Verify that bridgeplate deploys fully when platform stops at floor level. ▪ Verify bridgeplate rests flat against baseplate.
Front Rollstop	<ul style="list-style-type: none"> ▪ Verify that rollstop opens completely when platform contacts ground. ▪ Verify that rollstop closes and locks when platform leaves ground.
Hydraulic Power Unit	 CAUTION!
	Check and add fluid when platform is at GROUND level. Fluid that is added when platform is raised will overflow when platform is lowered.
	<ul style="list-style-type: none"> ▪ Verify that pump hydraulic fluid level is at FULL mark when platform is at <u>ground level</u>. Add Texaco 01554 Aircraft Hydraulic Oil or equivalent U.S. mil spec H5606G fluid. ▪ Verify there are no hydraulic fluid leaks. ▪ Verify that manual release valve is closed.
SIX MONTH SAFETY CHECK (or 1750 cycles of operation)	
Handrails	Verify that all handrail fasteners are properly tightened.
Cleaning and Lubrication	<ol style="list-style-type: none"> 1. Clean lift with mild soap and water and wipe dry. Prevent rust by coating all surfaces with a light oil. Remove excess oil. 2. Spray penetrating oil (Curtisol® Red Grease 88167 or WD-40®) where specified in Figure 3-1, following directions on container. Remove excess grease from surrounding areas.
 CAUTION!	
The annual safety check must be performed by an authorized Ricon dealer.	
ANNUAL SAFETY CHECK (or 3500 cycles of operation)	
Hydraulic Cylinder, Hoses and Fittings	<ul style="list-style-type: none"> ▪ Check hydraulic cylinder for evidence of leaks. ▪ Inspect hydraulic hoses for damage. ▪ Verify that all fittings are tight.
END OF TABLE	

D. LIFT DECALS

Refer to **Figure 3-1**. Inspect decals at intervals in **Table 3-1**. Inspect for chipping, peeling, fading, and illegibility. Order replacement decals with part number given in **Figure 3-1**, and apply where shown.

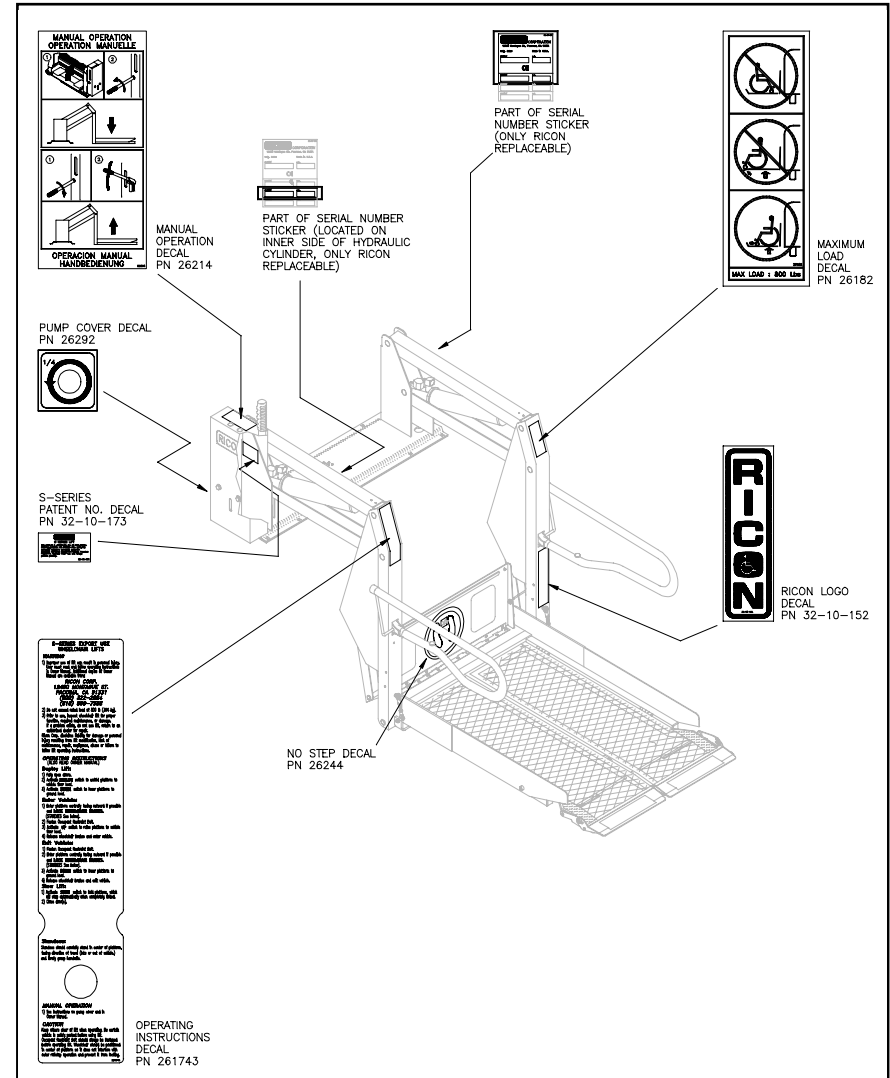

FIGURE 3-1: DECAL LOCATIONS AND PART NUMBERS

This page intentionally left blank.