



## INSTALLATION INSTRUCTIONS S/K-SERIES LIFTS ANTI-RATTLING BUMPER KIT (P/N: 45685)

- Be certain that these supplemental instructions are read and understood completely before installation is attempted. You should also refer to the Service/Owner Manual for additional installation instructions and safety precautions.
- Check contents of this kit and notify Ricon immediately of any missing parts. Claims for damages that have occurred during shipping must be made to the shipper.

### TABLE OF CONTENTS

### PAGE

I. INTRODUCTION .....	1
II. S/K SERIES INSTALLATION .....	2

- Under no circumstances is maintenance, repair, or adjustment of the product to be performed without the presence of an individual capable of giving aid.
- This lift is driven with hydraulic pressure generated by a hydraulic pump system. The fluid is highly pressurized and possibly very hot. Use extreme caution when doing maintenance and repairs. DO NOT disconnect hoses or fittings when lift is in motion.
- Give immediate attention to all injuries, and administer first-aid, or seek medical attention as necessary.
- Protective eye shields and clothing should be worn during maintenance, repair, and adjustment of the lift.
- Work in a properly ventilated area.
- Check for hidden obstructions before drilling and cutting. Avoid interference with wiring, fuel tank, fuel lines, hydraulic lines, subfloor members, etc.
- Read and understand all instructions before attempting to operate the product.
- Read and understand all instructions before attempting to perform maintenance, repairs, or adjustments to the product.
- Read and comply with warning labels attached to lift.
- Refer to S-Series Service Manual for part numbers of replacement parts mentioned here.

### I. INTRODUCTION

The following instructions are intended to cover installation of the Kick-Out Spring Kit for all S-Series lifts. This kit includes all the parts needed to complete the installation. Please follow these instructions thoroughly and do not cut any corners, or eliminate any steps. Call Ricon Product Support if you need assistance.

#### A. TOOLS REQUIRED

3/4" bore diameter external retaining ring pliers.  
PVC Hammer  
7/16 Wrenches  
3/4" Punch pin  
Center punch  
Drill Motor with 1/2 Chuck  
Size "V" Drill Bit

#### B. PARTS REQUIRED

P/N: 45633, Bumper, 3.5"x2.2"dia, Rubber

#### C. MODIFIED PARTS

P/N: 30863, Knuckle Link

## II. S/K SERIES ANTI-RATTLING RUBBER BUMPER INSTALLATION

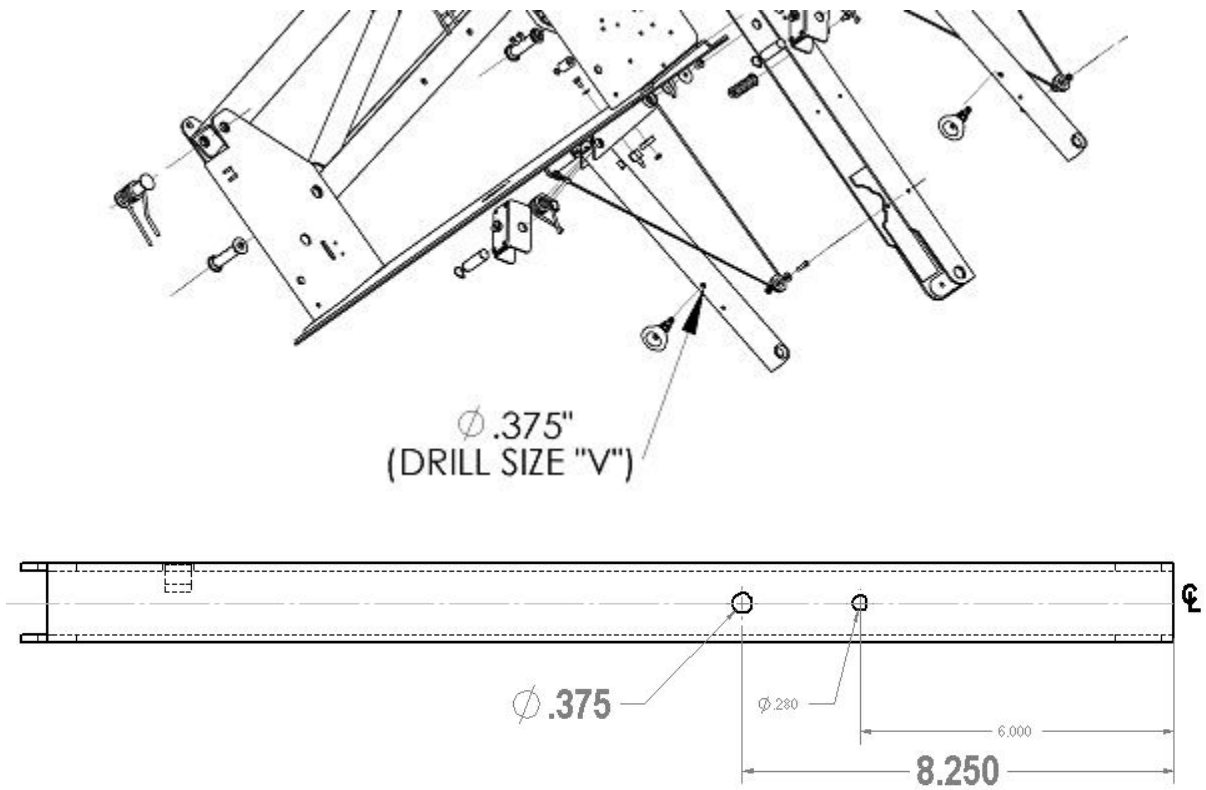
### A. PREPARATION OF DRILL MOUNTING HOLES

**NOTE:** Inspect lift to verify if the lift has factory pre-drilled holes. Continue to Step B installation if pre-drilled holes are present. If the pre-drilled holes are not present then continue with preparation of drill mounting holes.

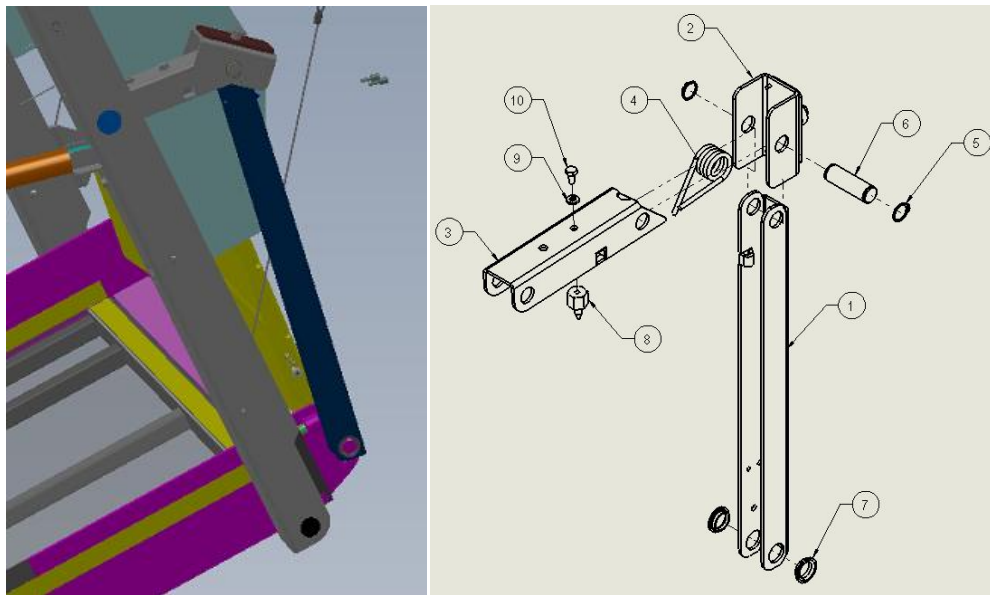
1. Deploy and lower the lift platform to ground level.
2. Use retaining ring pliers to remove snap rings (P/N: 14-31-075, ITEM#5) off knuckle assembly as shown in **FIGURE [2]**.
3. Use punch pin tool and PVC hammer to remove ITEM#6, snap ring pin off knuckle assembly on the lift as illustrated in **FIGURE [2]**.
4. Remove the knuckle link (P/N: 30863, ITEM#1) off the knuckle link assembly.
5. Locate mounting hole locations on knuckle link (P/N: 30863) as illustrated on **FIGURE [1]**.
6. Spot the location with center punch and drill through the knuckle link.
7. Remove all burrs before proceeding.
8. Repeat the process for the opposite side of the lift.

### D. INSTALLATION OF ANTI-RATTLING RUBBER BUMPER

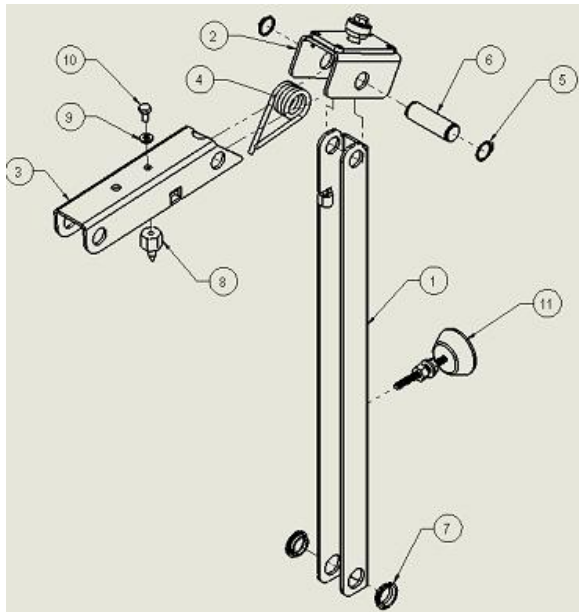
1. Install item #7, (PN: 25386, BEARING, DU FLG, 3/4IDx1/4L) and item #11, (PN: 45633, BUMPER, 3.5"X2.2"DIA RUBBER) on item #1, (PN: 30863, KNUCKLE LINK) as shown on **FIGURE [3]**.
2. Install the modified knuckle link assembly back onto the lift and reinstall the snap rings (P/N: 14-31-075) as shown on **FIGURE [3]**.
3. Be sure lift function normally after installation.
4. Operate the lift to its STOW position.
5. Loosen the nuts on anti-rattling rubber bumper assembly (PN: 45633) and move it toward the vertical arm until it touches it.
6. Tighten the nuts as shown on **FIGURE [5]**.
7. Repeat the process for the opposite side of the lift.
8. Deploy the lift to the floor level.
9. Loosen the nuts on the bumpers and move it about 1/2" away from the knuckle link assembly as illustrated on **FIGURE [6]**.
10. Tighten the rubber bumper assembly to the knuckle link assembly and torque the nuts to 25ft. lbs.
11. Repeat the process for the opposite side of the lift.
12. Installation Complete.



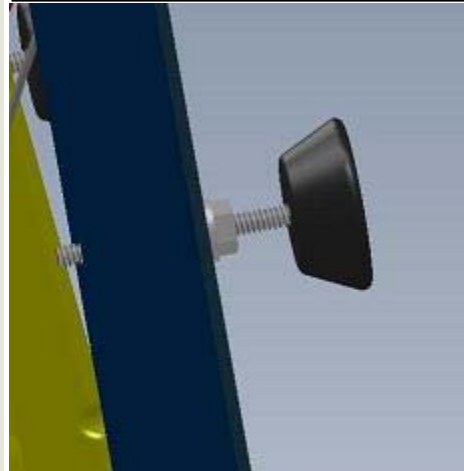
**FIGURE [1] HARDWARE LOCATION ON S/K SERIES**



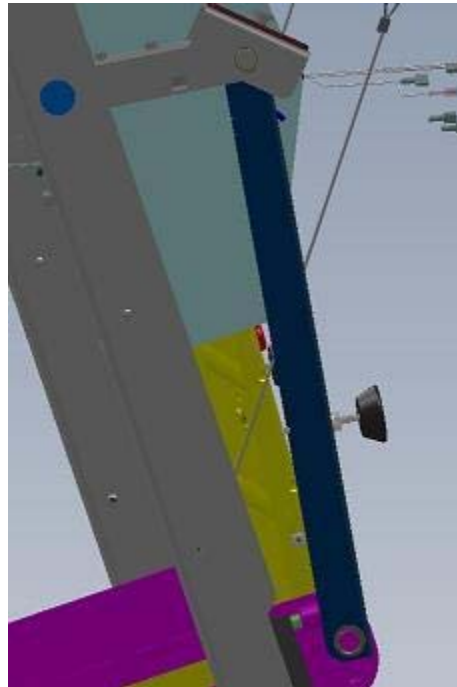
**FIGURE [2]: P/N: 14-31-075, SNAP RING LOCATION**



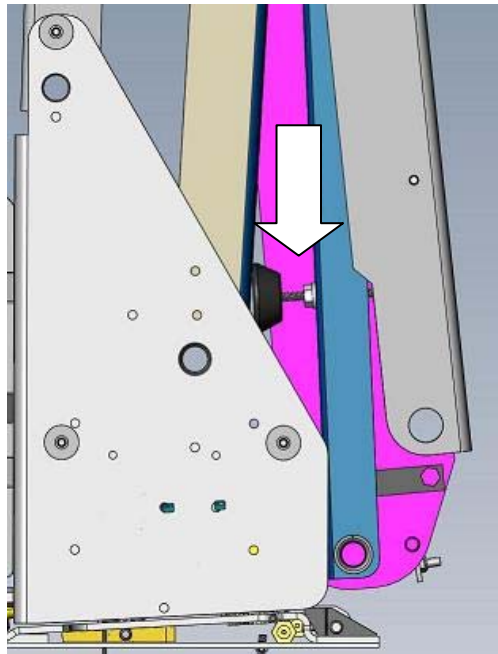
Note:  
Install the bumper 1/2" from the  
knuckle link as shown below.



**FIGURE [3] MODIFIED KNUCKLE LINK ASSEMBLY**

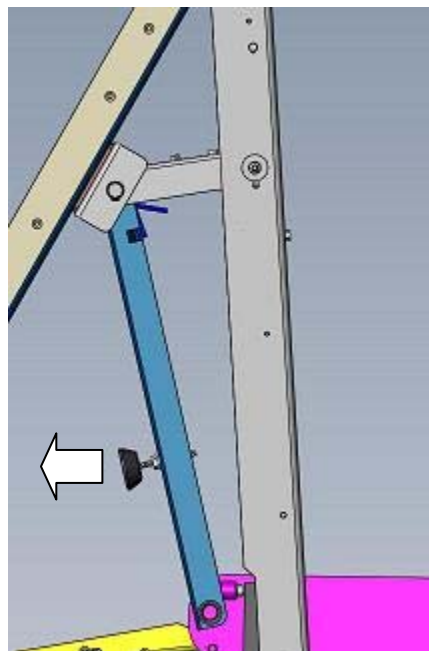


**FIGURE [4] ASSEMBLED KNUCKLE LINK ASSEMBLY**



**FIGURE [5] BUMPER INSTALLATION**

Move bumper  $\frac{1}{2}$   
inch from the  
knuckle link



**FIGURE [6] BUMPER INSTALLATION ADJUSTMENT**

## NOTES