



RETROFIT INSTRUCTIONS
FLANGED BUSHING & THRUST WASHER / FR2 FoldOver RAMP
KIT # 42496

- Be certain that these supplemental instructions are read and understood completely before installation is attempted. You should also refer to the Service/Owner Manual for additional installation instructions and safety precautions.
- Check contents of this kit and notify Ricon immediately of any missing parts. Claims for damages that have occurred during shipping must be made to the shipper.

TABLE OF CONTENTS	PAGE
I. INTRODUCTION	1
II. RETROFIT INSTRUCTIONS.....	3

- Under no circumstances is maintenance, repair, or adjustment of the product to be performed without the presence of an individual capable of giving aid.
- Give immediate attention to all injuries, and administer first-aid, or seek medical attention as necessary.
- Protective eye shields and clothing should be worn during maintenance, repair, and adjustment of the lift.
- Work in a properly ventilated area.
- Check for hidden obstructions before drilling and cutting. Avoid interference with wiring, fuel tank, fuel lines, hydraulic lines, subfloor members, etc.
- Read and understand all instructions before attempting to operate the product.
- Read and understand all instructions before attempting to perform maintenance, repairs, or adjustments to the product.
- Read and comply with warning labels attached to ramp.

I. INTRODUCTION

The purpose of this document is to outline the step by step procedure for installation of the product.

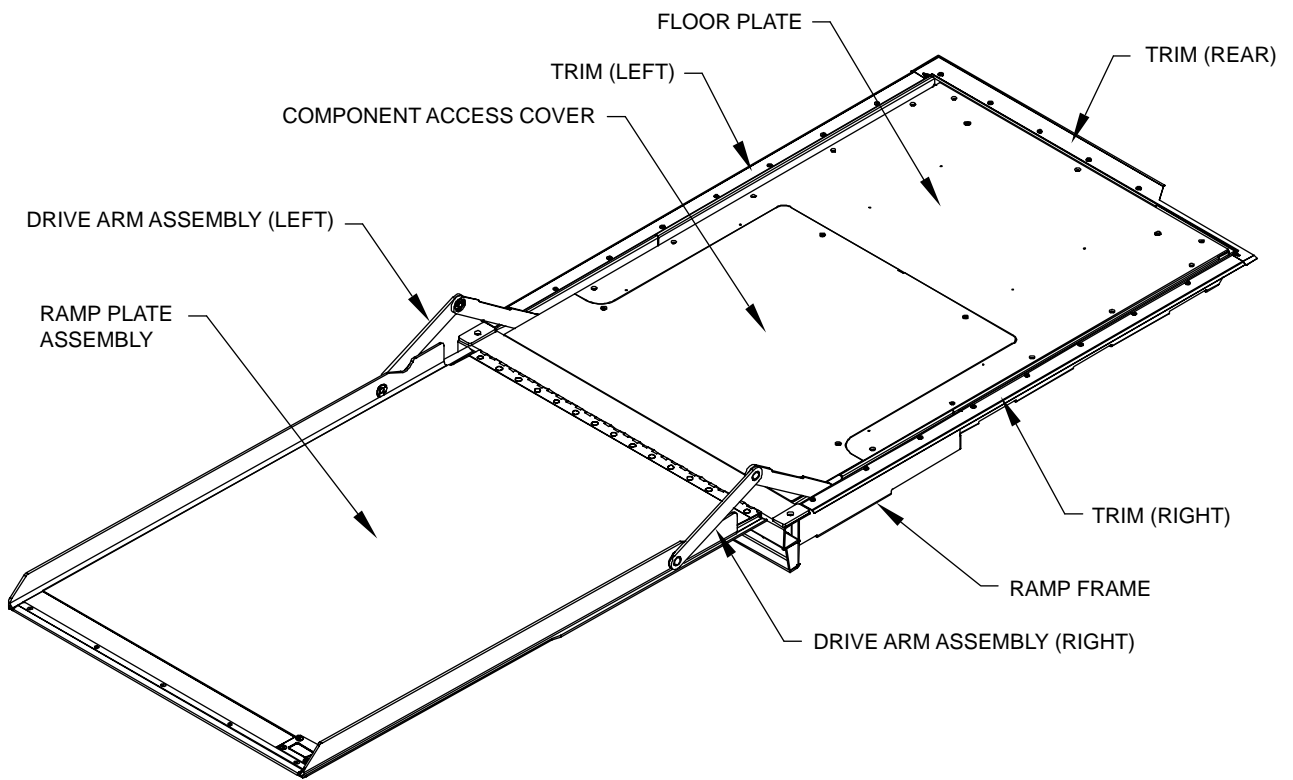

RSM0010500

FIGURE 1: GENERAL VIEW OF LIFT MECHANICAL COMPONENTS

II. RETROFIT INSTRUCTIONS

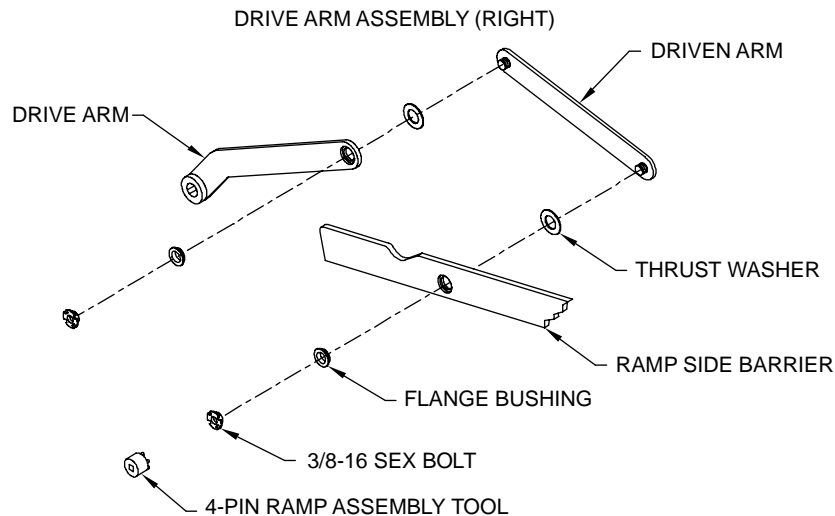

RSM0010400

FIGURE 2: COMPONENT DETAIL OF TYPICAL DRIVE ARM ASSEMBLY

A. MECHANICAL REMOVAL

1. Deploy lift using control pendant.
2. Remove power from lift.
3. Locate Drive Arm Assembly (Left) and Drive Arm Assembly (Right). Both sides are similar. Refer to **FIGURE 1**.
4. Begin with Drive Arm Assembly (Right). Refer to **FIGURE 2**.
5. Using the Tool, 4-Pin (Ricon P/N 21837) - remove Bolt, Sex, 3/16. Refer to **FIGURE 2**.
6. Remove existing Flange Bushing. Refer to **FIGURE 2**.
7. Remove existing Thrust Washer. Refer to **FIGURE 2**.
8. Repeat Steps 5, 6, 7 above for the Drive Arm Assembly (Left.)

B. MECHANICAL INSTALLATION

9. Locate Drive Arm Assembly (Right.) Install new Thrust Washer. Refer to **FIGURE 2**.
10. Locate Drive Arm Assembly (Right.) Install new Flange Bushing. Refer to **FIGURE 2** for proper orientation.
11. Locate Drive Arm Assembly (Right.) Install Bolt, Sex, 3/8-16. Use Blue Loc-Tite on threads to secure Bolt, Sex, 3/8-16. Allow Blue Loc-Tite to dry before deploying ramp. Tighten with Tool, 4-Pin. Refer to **FIGURE 2** for proper orientation.
12. Repeat Steps 9, 10, 11 above to the Drive Arm Assembly (Left). Refer to **FIGURE 2**.
13. Install power to Lift. Test Lift to ensure proper working condition.