



## INSTALLATION INSTRUCTIONS CYLINDER GLAND NUT AND PISTON REPLACEMENT KIT #21829

- Be certain that these supplemental instructions are read and understood completely before installation is attempted. You should also refer to the Service/Owner Manual for additional installation instructions and safety precautions.
- Check contents of this kit and notify Ricon immediately of any missing parts. Claims for damages that have occurred during shipping must be made to the shipper.

### TABLE OF CONTENTS

### PAGE

I. INTRODUCTION .....	1
II. REMOVAL AND INSTALLATION OF GLAND NUT AND PISTON.....	2

- Under no circumstances is maintenance, repair, or adjustment of the product to be performed without the presence of an individual capable of giving aid.
- This lift is driven with hydraulic pressure generated by a hydraulic pump system. The fluid is highly pressurized and possibly very hot. Use extreme caution when doing maintenance and repairs. DO NOT disconnect hoses or fittings when lift is in motion.
- Give immediate attention to all injuries, and administer first-aid, or seek medical attention as necessary.
- Protective eye shields and clothing should be worn during maintenance, repair, and adjustment of the lift.
- Work in a properly ventilated area.
- Check for hidden obstructions before drilling and cutting. Avoid interference with wiring, fuel tank, fuel lines, hydraulic lines, subfloor members, etc.
- Read and understand all instructions before attempting to operate the product.
- Read and understand all instructions before attempting to perform maintenance, repairs, or adjustments to the product.
- Read and comply with warning labels attached to lift.
- Refer to Slide-Away Service Manual for part numbers of replacement parts mentioned here.

### I. INTRODUCTION

The purpose of this document is to outline the step by step procedure for replacing the cylinder seal.

#### A. TOOLS REQUIRED

3/16" Hex Wrench	Pipe or Chain Wrench	Undersized Driver Pin
5/32" Hex Wrench	Split Cup Tool, P/N V2-AC-69	Wire brush
Large Flat Screw Driver	Medium Strength Thread Lock (Blue)	

#### B. KIT COMPONENTS

Part Number	Description
42304	Piston Assembly
42305	Gland Assembly



## WARNING!

EXERCISE CAUTION WHEN MANIPULATING HYDRAULIC COMPONENTS. THEIR PRECISION FINISH AND SOFT SEALS MAY EASILY BECOME DAMAGED BY HITTING OR DROPPING.

### II. REMOVAL AND INSTALLATION OF GLAND NUT AND PISTON

1. Lower lift to ground level.

**NOTE:** Lift must be lowered as far as possible to avoid personal injury and oil spillage when hydraulic components are dismantled.

2. Fully open manual release valve.

**NOTE:** Important for allowing easy removal/insertion of ram into cylinder.

3. Install hydraulic breather tube if available.

**NOTE:** The hydraulic breather tube may help in avoiding oil overflow from filler neck when reinstalling ram. An assistant may be required to check oil level in filler neck as ram is reinserted, if breather tube is not available.

4. Loosen both hydraulic button head screws with 3/16" hex wrench to loosen pin.
5. Remove and retain cap screw with 5/32" hex wrench.
6. Refer to **Figure 1**. Drive rear pin out and retain. Use pin driver, pin is driven towards BUSHING SIDE.

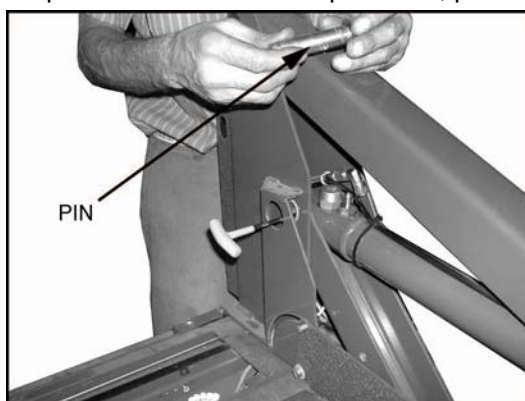

**FIGURE 1**

7. Refer to **Figure 2**. If present, remove rear spring. Use larger screw driver to pry spring and arm upward. Spring applies to Slide-Away lifts only.

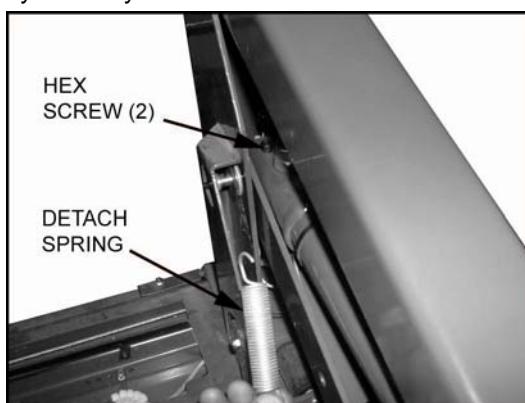

**FIGURE 2**

8. Drive front pin out and retain.

**NOTE:** Hydraulic cylinder may be left in baseplate "U" tower for this and proceeding operations.

9. Refer to **Figure 3**. Unscrew gland nut.
10. Refer to **Figure 3**. Pull shaft out.

11. Refer to **Figure 3**. Remove old piston using appropriate tool. Heat piston thread if required to soften the thread lock and remove piston.

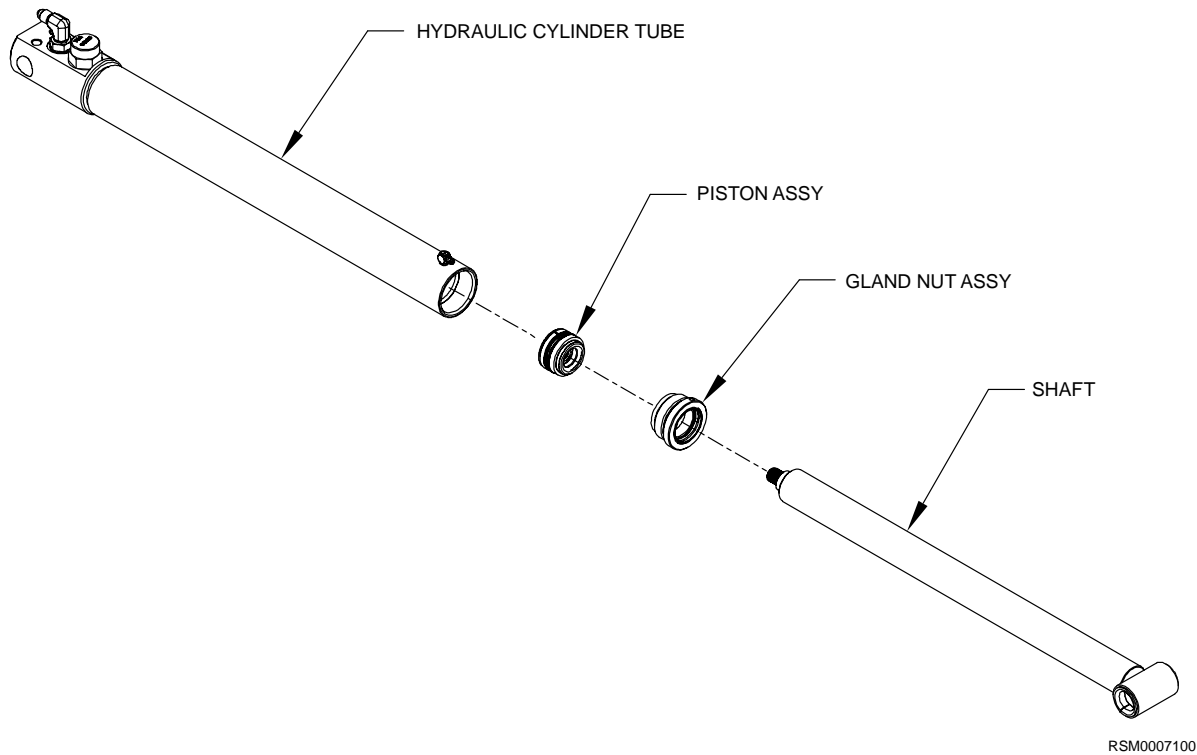

**FIGURE 3: HYDRAULIC CYLINDER**

12. Refer to **Figure 3**. Replace gland nut with the gland nut supplied in kit. Apply thin film of hydraulic fluid to the seals before installing.
13. Thoroughly clean shaft and new piston threads.

**NOTE:** If shaft threads were damaged by the thread locking punch, rethread with 1/2-20 die. Use a wire brush to remove all thread sealer from shaft threads. Blow clean. Always blow piston threads clean even if no dirt is visible.

14. Refer to **Figure 3**. Install new piston supplied in kit. Apply medium strength thread lock (blue) on shaft threads and tighten securely.
15. Refer to **Figure 3**. Reinsert shaft into cylinder. Apply thin film of hydraulic fluid to seals before installing. Use split cup tool to insert piston.

**NOTE:** Be extra careful not to damage piston seals.

16. Firmly tighten gland nut. Apply medium strength thread lock (blue) on gland nut threads.
17. Install front pin. Place set screw face down. Apply medium strength thread lock (blue) on cap screw. Tighten using 5/32" hex wrench.
18. Install rear spring using spring installation tools.
19. Install rear pin. Insert pin from bushing side. Apply medium strength thread lock (blue) to button head screw. Tighten using 3/16" hex wrench.